

**WELWYN HATFIELD BOROUGH COUNCIL**

**ROAD TRAFFIC REGULATION ACT 1984**

**THE BOROUGH OF WELWYN HATFIELD (VARIOUS ROADS, BIRCHWOOD,  
HATFIELD) (RESTRICTION OF WAITING) ORDER 2019**

The Welwyn Hatfield Borough Council (hereinafter referred to as "the Council") pursuant to arrangements made with Hertfordshire County Council ("the County Council") under Section 19 of the Local Government Act 2000 and The Local Authorities (Arrangements for the Discharge of Functions) (England) Regulations 2012 in exercise of the powers conferred under Sections 1, 2, and 3 of the Road Traffic Regulation Act 1984 ("the Act of 1984"), and of all other enabling powers and after consultation with the Chief Officer of Police in accordance with Part III of Schedule 9 of the Act of 1984, hereby makes the following Order:-

1. This Order may be cited as "The Borough of Welwyn Hatfield (Various Roads, Birchwood, Hatfield) (Restriction of Waiting) Order 2019" and shall come into effect on Monday 12<sup>th</sup> August 2019
2. Save as provided in Articles 3, 4 and 5(1) of this Order, no person shall cause or permit any vehicle to wait at any time in those lengths of road specified in the Schedule to this Order.
3. (1) Nothing in Article 2 of this Order applies to the lengths of road restricted by those Articles (which said lengths of road are referred to in this Article as "the restricted area") in relation to-
  - (a) A vehicle being used for Fire and Rescue, Ambulance or Police purposes.
  - (b) Anything done with the permission of or at the direction of a police constable in uniform; or with the permission of a Civil Enforcement Officer as defined by the Traffic Management Act 2004 and appointed by Welwyn Hatfield Borough Council.
  - (c) A vehicle which is prevented from proceeding by circumstances beyond the drivers control or which has stopped in order to avoid injury or damage to persons or property or when required to do so by law;
  - (d) A vehicle which is stationary in order that it may be used for one or more of the purposes specified in sub-Article (2) of this Article and which cannot reasonably be used for such a purpose without stopping in the restricted area;
  - (e) A marked vehicle which, whilst used by a universal service provider in the course of the provision of a universal postal service, is stationary only for so long as may be reasonably necessary for postal packets to be delivered or collected;

In this Article –

The expressions "universal service provider", "provision of a universal postal Service" and "postal packet" shall bear the same meanings as in the Section 65 of the Postal Services Act 2011.

3. (2) The "purposes" referred to in sub-Article (1)(d) of this Article are –
  - (a) any operation involving building, demolition or excavation;
  - (b) the removal of any obstruction to traffic;
  - (c) the maintenance, improvement or reconstruction of a road;
  - (d) constructing, improving, maintaining, or cleaning of any street furniture; or

- (e) the laying, erection, alteration, repair or cleaning of any sewer or of any main pipe or apparatus for the supply of gas, water or electricity, or of any telecommunications apparatus kept or installed for the purposes of a telecommunications code system or of any other telecommunications apparatus lawfully kept installed in any position.
4. Nothing in Article 2 of this Order applies to the lengths of road restricted by those Articles (which said lengths of road are referred to in this Article as "the restricted area") so as to render it unlawful to cause or permit any vehicle to wait only for so long as may be reasonably necessary –
- (a) To enable goods to be loaded on or unloaded from the vehicle from or to premises adjacent to the restricted area; or
  - (b) To enable a passenger to board or alight and to load and unload any luggage.
5. (1) Nothing in Article 2 of this Order shall render it unlawful to cause or permit a disabled person's vehicle which displays in the relevant position a disabled person's badge and a parking disc, to wait at any time in the lengths of road specified in the Schedule of this Order for a period not exceeding 3 hours (not being a period separated by an interval of less than 1 hour from a previous period of waiting by the same vehicle in the same length of road).
- (2) In this Article –
- "disabled person's vehicle" has the same meaning as in Section 142(1) of the Act of 1984;
- "disabled person's badge" has the same meaning as given in Regulation 3(1) of The Local Authorities' Traffic Orders (Exemptions for Disabled Persons) (England) Regulations 2000
- "parking disc" has the same meaning as given in Regulation 8(5) of The Local Authorities' Traffic Orders (Exemptions for Disabled Persons) (England) Regulations 2000; and
- "relevant position" has the same meaning as given in Regulation 4 of The Local Authorities' Traffic Orders (Exemptions for Disabled Persons) (England) Regulations 2000.
6. The provisions of the following Order are hereby revoked but only in so far as they are affected by the restrictions imposed by this Order and the relevant schedule:
- The Borough of Welwyn Hatfield (Control of Parking) (Consolidation) Order 2017
7. The Interpretation Act 1978 shall apply for the interpretation of this Order as it applies for the interpretation of an Act of Parliament.
8. The restrictions imposed by this Order shall be in addition to and not in derogation from any restriction or requirement imposed by any other regulations made or having effect as if made under the Act of 1984 or by or under any other enactment.



Schedule :		
No waiting at any time		
Road & Side	Length and description	
West View (Northwest side)		From a point in line with the north kerbline of Birchwood Avenue north-westwards for 9 metres
West View (Northeast side)		From a point in line with the north kerbline of Birchwood Avenue north-westwards for 19 metres
Birchwood Close (Southeast side)		The entire length of the circumference of the grass island facing odd numbers 23-79 and even numbers 34-50 Birchwood Close
Talbot Road (Both Sides)	a	From a point in line with the southwest kerbline of Homestead Road south-westwards for 10 metres
	b	From a point in line with boundary of 3 and 5 Talbot Road south-westwards for 17.5 metres to a point 4.5 metres northeast of a point in line with the boundary of 9 and 11 Talbot Road
	c	From a point 3.5 metres southwest of a point in line with boundary of 9 and 11 Talbot Road south-westwards for 18.5 metres to a point 10 metres northeast of a point in line with the projected boundary of 46 and 48 Talbot Road
	d	From a point in line with the boundary of 25 and 27 Talbot Road south-westwards for 22.5 metres to a point in line with the boundary of 31 and 33 Talbot Road
Talbot Road (Northwest side)		From a point 4.5 metres southwest of a point in line of the boundary of 48 and 50 Talbot Road south-westwards for 39 metres to a point 16.5 metres northeast of a point in line with the projected boundary of 13 and 15 Talbot Road
Talbot Road (Southeast side)	a	From a point in line with the northeast kerbline of Green Croft north-eastwards for 10 metres
	b	From a point in line with the southwest kerbline of Green Croft south-westwards for 24 metres
Green Croft (Both sides)		From a point in line with the southeast kerbline of Talbot Road south-eastwards for 10 metres
Homestead Road (Southwest side)	a	From a point in line with the southeast kerbline of Talbot Road south-eastwards for 10 metres
	b	From a point in line with the northwest kerbline of Chelwood Avenue north-westwards for 10 metres
	c	From a point in line with the southeast kerbline of Chelwood Avenue south-eastwards for 10 metres
	d	From a point in line with the northwest kerbline of Heathcote Avenue north-westwards for 10 metres
	e	From a point in line with the southeast kerbline of Heathcote Avenue south-eastwards for 10 metres

	f	From a point in line with the northwest kerbline of Crawford Road north-westwards for 10 metres
Homestead Road (Northeast side)	a	From a point in line with the northwest kerbline of Burnside Close north-westwards then south-westwards for 22 metres to a point in line with the northwest kerbline of Talbot Road
	b	From a point in line with the southeast kerbline of Burnside Close south-eastwards for 10 metres
	c	From a point in line with the northwest kerbline of Longmead north-westwards for 10 metres
	d	From a point in line with the southeast kerbline of Longmead south-eastwards for 10 metres
	e	From a point in line with the northwest kerbline of Lockley Crescent north-westwards for 10 metres
Chelwood Avenue (Both sides)		From a point in line with the southwest kerbline of Homestead Road south-westwards for 10 metres
Heathcote Avenue (Both sides)		From a point in line with the southwest kerbline of Homestead Road south-westwards for 10 metres
Crawford Road (Northwest side)	a	From a point in line with the southwest kerbline of Homestead Road south-westwards for 10 metres
	b	From a point in line with the southwest kerbline of Birchway south-westwards for 21 metres to a point 12 metres northeast of a point in line with the boundary of 116 and 118 Crawford Road
	c	From a point in line with the northeast kerbline of Birchway north-eastwards for 13 metres to a projected point in line with the boundary of 143 and 145 Crawford Road
Birchway (Both Sides)		From a point in line with the northwest kerbline of Crawford Road north-westwards for 10 metres
Burnside Close (Both sides)		From a point in line with the northeast kerbline of Homestead Road north-eastwards for 10 metres
Longmead (Northwest side)	a	From a point in line with the northeast kerbline of Jubilee Court north-eastwards for 10 metres



	b	From a point in line with the southwest kerbline of Jubilee Court south-westwards for 10 metres
	c	From a point in line with the northeast kerbline of Northfield Western Access Road eastwards for 10 metres
	d	From a point in line with the southwest kerbline of Northfield Western Access Road south-westwards for 10 metres
Longmead (North side)	a	From a point in line with the west kerbline of Northfield Eastern Access Road westwards for 10 metres
	b	From a point in line with the east kerbline of Northfield Eastern Access Road eastwards for 10 metres
	c	From a point in line with the northeast kerbline of Access Road to Birchwood Leisure Centre north-eastwards for 10 metres
	d	From a point in line with the southwest kerbline of Access Road to Birchwood Leisure Centre south-westwards for 10 metres
	e	From a point 92 metres northeast of a projected point of the northeast kerbline of Warren Green north-eastwards for 13 metres
	f	From a point 118 metres northeast of a projected point of the northeast kerbline of Warren Green south-westwards for 13 metres
	g	From a point 76 metres southwest of a projected point in line with the boundary of 59 and 61 Longmead south-eastwards for 13 metres
	h	From a point 49 metres southwest of a projected point in line with the boundary of 59 and 61 Longmead south-westwards for 13 metres
	i	From a point 18.5 metres southwest of a projected point in line with the boundary of 59 and 61 Longmead south-eastwards for 12.5 metres
Longmead (South side)	a	From a point in line with the boundary of 29 and 31 Longmead north-eastwards for 11.5 metres
	b	From a point in line with the southwest kerbline of Warren Green westwards for 10 metres
	c	From a point in line with the northeast kerbline of Warren Green north-eastwards for 10 metres

	d	From a point 24 metres southwest of a point in line with the northwest kerbline of Cornerfield south-westwards for 26.5 metres
	e	From a point in line with the northwest kerbline of Cornerfield south-westwards for 10 metres
	f	From a point in line with the southeast kerbline of Cornerfield north-eastwards for 20 metres
	g	From a point in line with the southwest kerbline of Hillfield south-westwards for 5.5 metres
	h	From a point in line with the northeast kerbline of Hillfield north-eastwards for 25 metres to a point in line of the boundary of 61 and 63 Longmead
Longmead (Both sides)		From a point in line with the northeast kerbline of Homestead Road north-eastwards for 10 metres
Jubilee Court (Both sides)		From a point in line with the northwest kerbline of Longmead north-westwards for 10 metres
Northfield Western Access Road (Both sides)		From a point in line with the northwest kerbline of Longmead north-westwards for 10 metres
Northfield Eastern Access Road (Both sides)		From a point in line with the northwest kerbline of Longmead northwards for 10 metres
Access Road to Birchwood Leisure Centre (Both sides)		From a point in line with the north kerbline of Longmead northwards for 10 metres
Warren Green (Both sides)	a	From a point in line with the south kerbline of Longmead north-westwards for 10 metres
	b	From a point in line with the northwest kerbline of Cornerfield north-westwards for 10 metres
Warren Green (Southwest side)	a	From a point in line with the northwest kerbline of Warren Close north-westwards for 10 metres
	b	From a point in line with the southeast kerbline of Warren Close south-eastwards for 10 metres
Warren Close (Both sides)		From a point in line with the southwest kerbline of Warren Green south-westwards for 10 metres

Warren Close (East side)		The entire length of the circumference of the grass island facing odd numbers 9-29 and even numbers 10-30 Warren Close
Cornerfield (Both sides)		From a point in line with the south kerbline of Longmead south-westwards for 7 metres
Cornerfield (Northwest side)	a	From a point in line with the northeast kerbline of Warren Green north-eastwards for 10 metres
	b	From a point in line with the southwest kerbline of Warren Green south-westwards for 10 metres
Cornerfield (Southeast side)	a	From a point in line with the northeast kerbline of Wood Common north-eastwards for 10 metres
	b	From a point in line with the southwest kerbline of Wood Common south-westwards for 10 metres
	c	From a point in line with the northeast kerbline of Little Mead north-eastwards for 10 metres
	d	From a point in line with the southwest kerbline of Little Mead south-westwards for 10 metres
Wood Common (Both sides)		From a point in line with the southeast kerbline of Cornerfield south-eastwards for 10 metres
Wood Common (Northeast side)	a	From a point 9 metres southeast of a point in line with the boundary of 19 and 21 Wood Common following the kerbline south-eastwards then north-eastwards for 20 metres
	b	From a point 35 metres southeast of a point in line with the boundary of 19 and 21 Wood Common following the kerbline north-westwards then north-eastwards for 20 metres
	c	From a point 50 metres southeast of a point in line with the boundary of 19 and 21 Wood Common following the kerbline north-westwards then north-eastwards for 13.5 metres
Wood Common (Southwest side)	a	From a point 3 metres southeast of a point in line with the boundary of 10 and 12 Wood Common following the kerbline southwards then south-westwards for 20 metres
	b	From a point 30 metres southeast of a point in line with the boundary of 10 and 12 Wood Common following the kerbline northwards then south-westwards for 20 metres



Little Mead (Both sides)		From a point in line with the southeast kerbline of Cornerfield south-eastwards for 10 metres
Hillfield (Southwest side)	a	From a point in line with the southeast kerbline of Great Heath south-eastwards for 10 metres
	b	From a point in line with the southeast kerbline of Longmead south-eastwards for 57 metres to a point in line with the northwest kerbline of Great Heath
Hillfield (Northeast side)	a	From a point in line with the southeast kerbline of Longmead south-eastwards for 25 metres to a point in line with the boundary of 59 Longmead and 1 Hillfield
	b	From a point in line with the south facing boundary wall of 9 Hillfield following the kerbline south-eastwards for 20 metres
	c	From a point in line with the north facing boundary wall of 59 Hillfield following the kerbline north-eastwards for 20 metres
	d	From a point in line with the boundary of 77 and 79 Hillfield following the kerbline south-eastwards for 20 metres
	e	From a point in line with the boundary of 93 and 95 Hillfield following the kerbline north-eastwards for 20 metres
Great Heath (Both sides)		From a point in line with the southwest kerbline of Hillfield south-westwards for 10 metres
Great Heath (Southwest side)		From a point in line with the boundary of 29 and 31 Great Heath following the kerbline south-eastwards for 20 metres
Great Heath (Southeast side)		From a point in line with the boundary of 5 and 7 Great Heath following the kerbline south-westwards then south-eastwards for 20 metres
Branch Close (Both sides)		From a point in line with the southeast kerbline of Lockley Crescent south-eastwards for 10 metres



Ground Lane (Northeast side)		From a point 15 metres southeast of a point in line with the southeast kerbline of Cecil Crescent south-eastwards for 10 metres
Crop Common (Northwest side)		From a point 19 metres southeast of a point in line with the south kerbline of Cobmead south-eastwards for 10 metres

GIVEN under the Common Seal of the Welwyn Hatfield Borough Council this 2nd day of July 2019

The COMMON SEAL of the WELWYN  
HATFIELD BOROUGH COUNCIL was )  
hereunto affixed in the presence of: - )



—Mayor—

*S. Saunders*

Authorised Officer

**WELWYN HATFIELD BOROUGH COUNCIL**

**THE BOROUGH OF WELWYN HATFIELD (VARIOUS ROADS, BIRCHWOOD, HATFIELD) (RESTRICTION OF WAITING) ORDER 2019**

**THE BOROUGH OF WELWYN HATFIELD (VARIOUS ROADS, BIRCHWOOD, HATFIELD) (PROHIBITION OF STOPPING AND WAITING ON VERGE OR FOOTWAY) ORDER 2019**

NOTICE IS HEREBY GIVEN that the Welwyn Hatfield Borough Council (pursuant to arrangement made with Hertfordshire County Council) has made the above Orders under the Road Traffic Regulation Act 1984 to introduce restrictions in **Various Roads, Birchwood, Hatfield**, as specified in the Schedule(s) to this Notice. The Orders will come into effect on Monday 12<sup>th</sup> August 2019

Documents giving more detailed particulars of the Orders may be inspected from Wednesday 3<sup>rd</sup> July to Thursday 15<sup>th</sup> August 2019 during normal office hours at the offices of Welwyn Hatfield Borough Council, The Campus, Welwyn Garden City or viewed at [www.welhat.gov.uk](http://www.welhat.gov.uk)

General enquiries relating to the Orders should be referred to Matthew McCann, Parking Services, Council Offices, Welwyn Garden City, AL8 6AE (01707 357000); email [parking@welhat.gov.uk](mailto:parking@welhat.gov.uk)

Any person wishing to question the validity of the Order, or of any provision contained in it, on the grounds that it is not within the powers conferred by the Road traffic Regulation Act 1984, or on the grounds that any requirement of the Act or any instrument made under it has not been complied with in relation to the Order, may within 6 weeks from the date of this Notice apply to the High Court for this purpose.

**SCHEDULE 1 - No waiting at any time (double yellow lines) - those sections of road(s) listed below as set out in the Order and accompanying plans**

Access Road to Birchwood Leisure Centre, Birchwood Close, Birchway, Branch Close, Burnside Close, Chelwood Avenue, Cornerfield, Crawford Road, Crop Common, Great Heath, Green Croft, Ground Lane, Heathcote Avenue, Hillfield, Homestead Road, Jubilee Court, Little Mead, Lockley Crescent, Longmead, Northfield, Talbot Road, Warren Close, Warren Green, West View, Wood Common

**SCHEDULE 2 - No stopping or waiting on verge or footway at any time – those sections of road(s) listed below as set out in the Order and accompanying plans**

Access Road to Birchwood Leisure Centre, Birchwood Avenue, Birchwood Close, Birchway, Branch Close, Chelwood Avenue, Cornerfield, Crawford Road, Drovers Way, Great Heath, Green Croft, Heathcote Avenue, Hillfield, Homestead Road, Little Mead, Lockley Crescent, Longmead, Northfield, Talbot Road, Warren Close, Warren Green, West View, Wood Common

Ka Ng  
Corporate Director  
Resources, Environment and Cultural Services  
Council Offices, The Campus, Welwyn Garden City, Herts AL8 6AE

3<sup>rd</sup> July 2019



WELWYN HATFIELD BOROUGH COUNCIL

STATEMENT OF REASONS FOR PROPOSING

**THE BOROUGH OF WELWYN HATFIELD (VARIOUS ROADS, BIRCHWOOD, HATFIELD) (RESTRICTION OF WAITING) ORDER 2019**

**THE BOROUGH OF WELWYN HATFIELD (VARIOUS ROADS, BIRCHWOOD, HATFIELD) (PROHIBITION OF STOPPING AND WAITING ON VERGE OR FOOTWAY) ORDER 2019**

Welwyn Hatfield Borough Council is proposing to introduce “no waiting at anytime” (double yellow lines), and also a prohibition of stopping and waiting on verge or footway in Various Roads, Hatfield.

Residents and businesses of the area were consulted on proposed parking restrictions to prevent parking on junctions and congestion. Parking on verges and footways is an unnecessary obstruction and inconvenience to other road users and causes damage to the highway and underground services. Existing by-laws in force prohibit parking on grass verges, however current legislation does not allow their enforcement by Civil Enforcement Officers.

The proposed restrictions:

**No waiting at any time**

- In parts of Access Road to Birchwood Leisure Centre, Birchwood Close, Birchway, Branch Close, Burnside Close, Chelwood Avenue, Cornerfield, Crawford Road, Crop Common, Great Heath, Green Croft, Ground Lane, Heathcote Avenue, Hillfield, Homestead Road, Jubilee Court, Little Mead, Lockley Crescent, Longmead, Northfield, Talbot Road, Warren Close, Warren Green, West View, Wood Common

**No stopping or waiting on verge or footway at any time**

- In parts of Access Road to Birchwood Leisure Centre, Birchwood Avenue, Birchwood Close, Birchway, Branch Close, Chelwood Avenue, Cornerfield, Crawford Road, Drivers Way, Great Heath, Green Croft, Heathcote Avenue, Hillfield, Homestead Road, Little Mead, Lockley Crescent, Longmead, Northfield, Talbot Road, Warren Close, Warren Green, West View, Wood Common

Having considered the duty imposed by Section 122 Road Traffic Regulation Act 1984, it appears to Welwyn Hatfield Borough Council that it is necessary and expedient to make the Order for the following reasons;

- **For the avoidance of danger to persons or other traffic using the road or any other road or for preventing the likelihood of any such danger arising**
- **For preventing the use of the road by vehicular traffic in a manner which, is unsuitable having regard to the existing character of the road or adjoining property.**
- **For facilitating the passage on the road or any other road of any class of traffic including pedestrians.**

The proposal has been subject to consultation with local and county councillors representing the area and Hertfordshire County Council. The local Police, Ambulance, Fire and Rescue Services and local residents.

Ka Ng  
Corporate Director  
Resources, Environment and Cultural Services  
Welwyn Hatfield Borough Council  
Council Offices, The Campus, Welwyn Garden City, Herts AL8 6AE

2<sup>nd</sup> July 2019



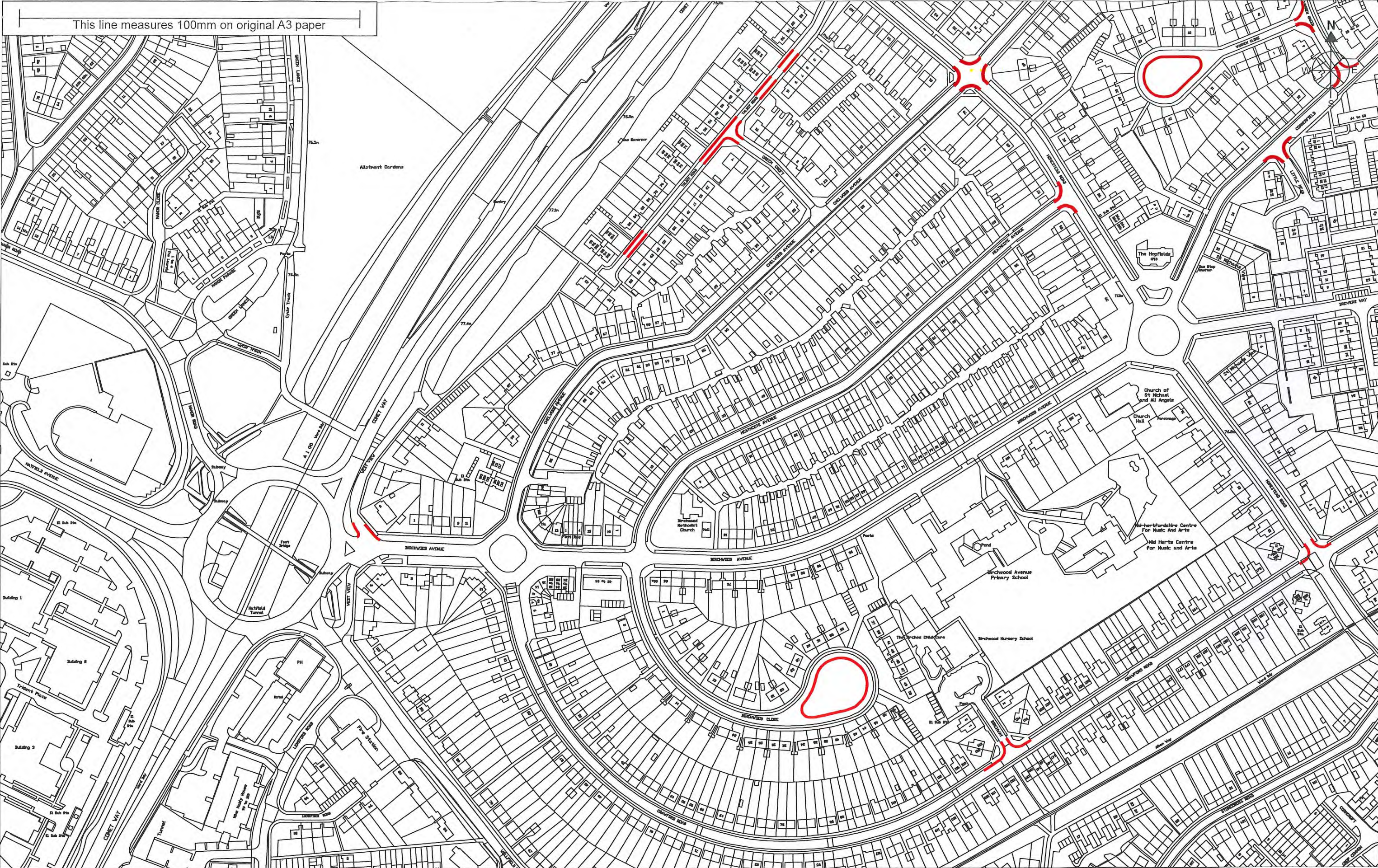

Title:- The Borough of Welwyn Hatfield (Various Roads, Birchwood, Hatfield) (Restriction of Waiting) Order 2019 - Map for West View - Homestead Road

Key:-

 Proposed Double Yellow Lines

Scale - 1:2500 on A3  
Drawn - 22/03/2019  
By - Parking Services - MM  
Drawing - Yellow Line Plan 1



© Crown Copyright All rights reserved Welwyn Hatfield  
Borough Council License No. LA 100019547 2019



This line measures 100mm on original A3 paper

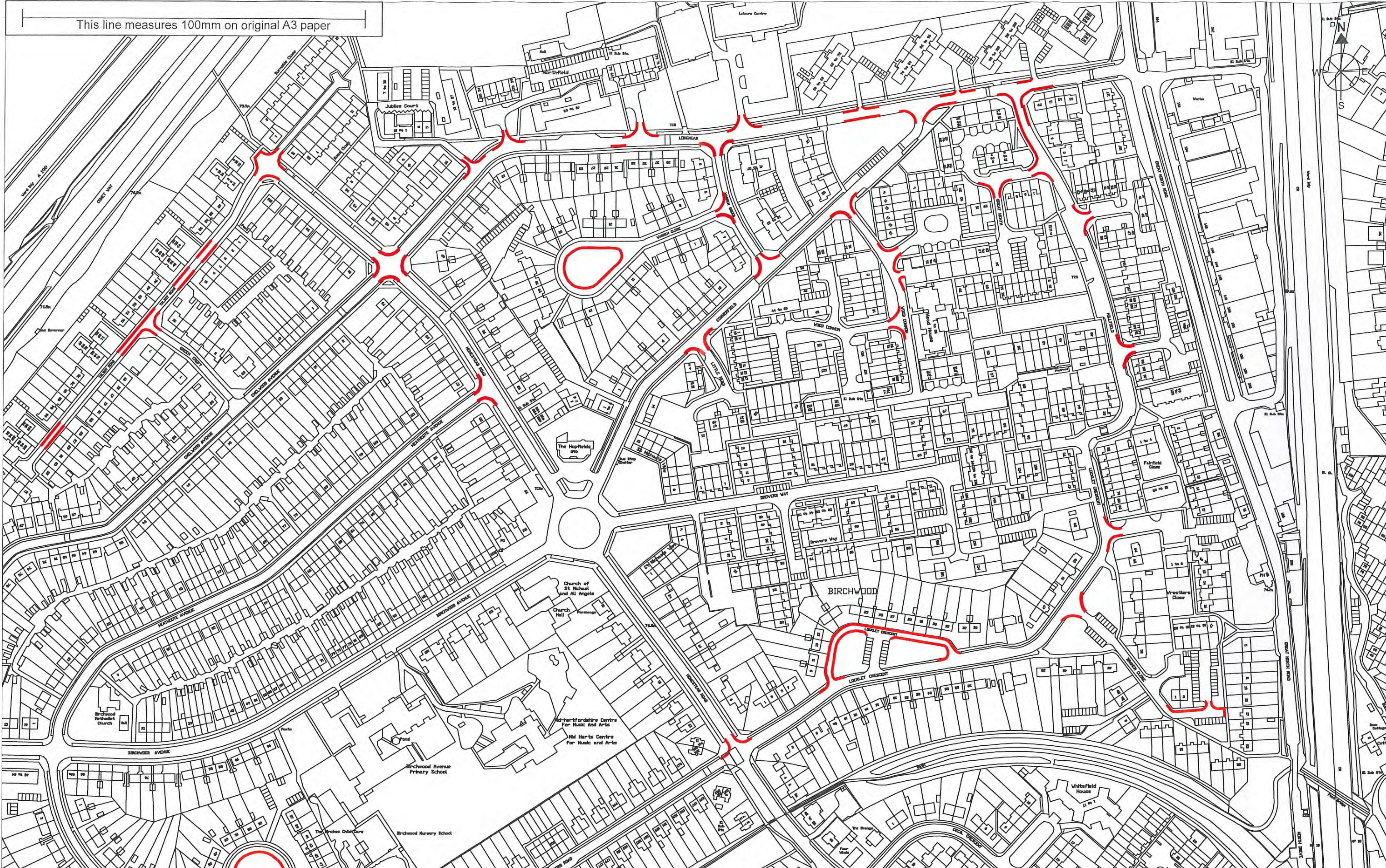

Title:- The Borough of Welwyn Hatfield (Various Roads, Birchwood, Hatfield) (Restriction of Waiting) Order 2019 - Map for Homestead Road - Hillfield

Key:-

 Proposed Double Yellow Lines

Scale - 1:2500 on A3  
 Drawn - 23/01/2019  
 By - Parking Services - MM  
 Drawing - Yellow Line Plan 2



© Crown Copyright All rights reserved Welwyn Hatfield  
Borough Council License No. LA 100019547 2019



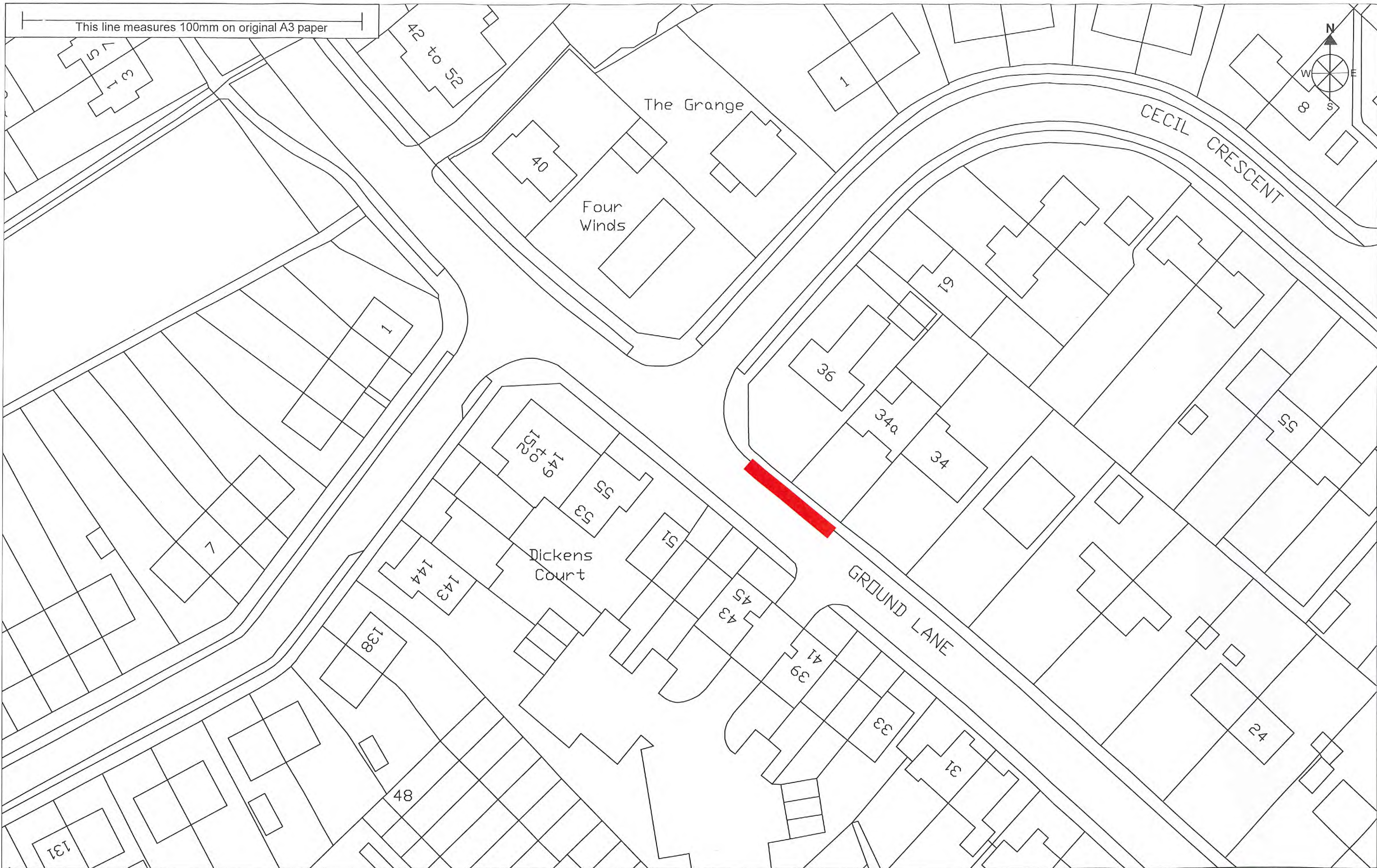



This line measures 100mm on original A3 paper

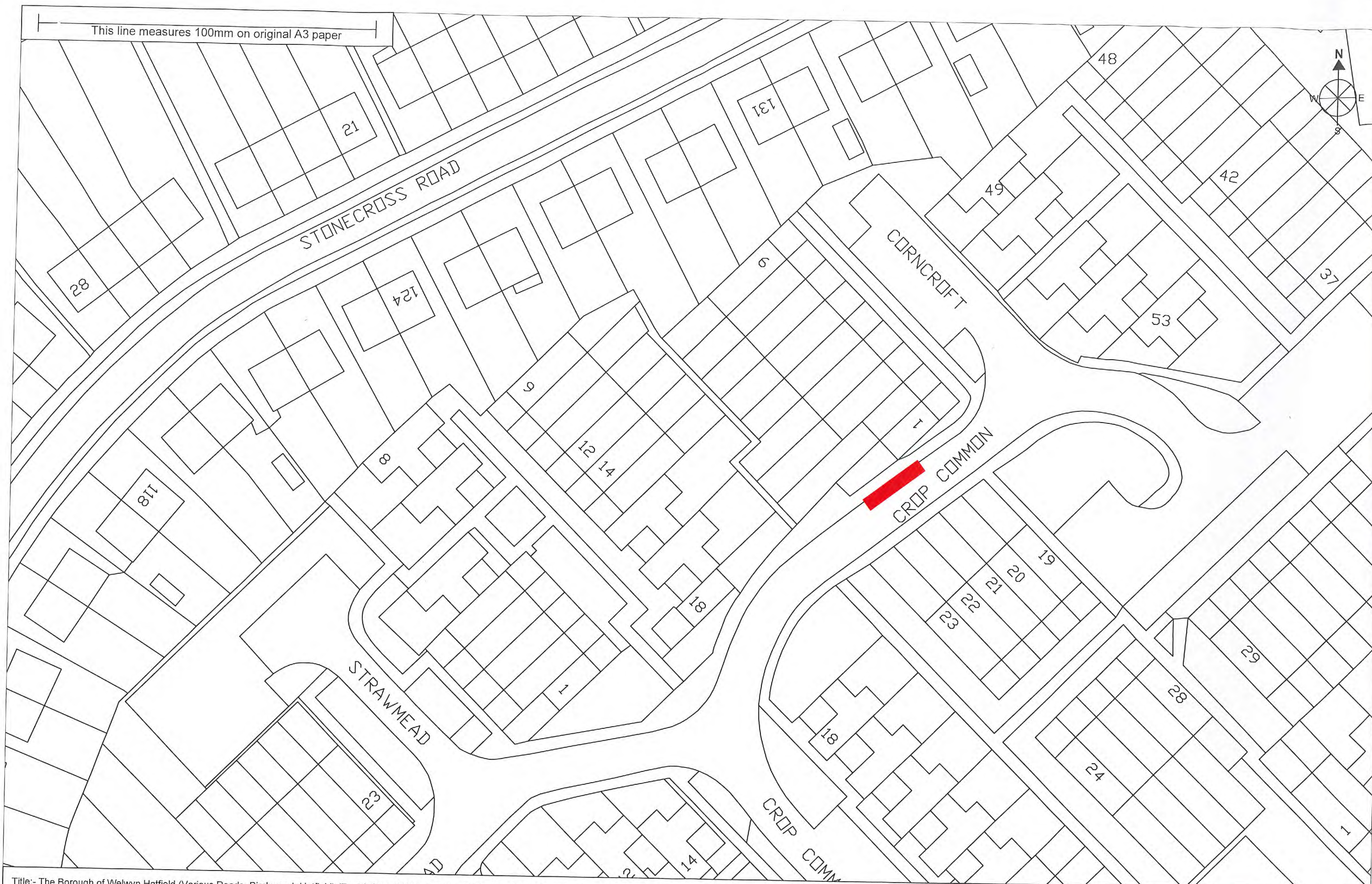
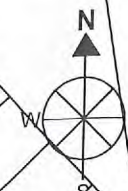

Title:- The Borough of Welwyn Hatfield (Various Roads, Birchwood, Hatfield) (Restriction of Waiting) Order 2019 - Plan for Crop Common

Key:-

 Proposed Double Yellow Lines

Scale - 1:500 on A3  
Drawn - 23/01/2019  
By - Parking Services - MM  
Drawing - 1 of 1



**WELWYN  
HATFIELD**

© Crown Copyright All rights reserved Welwyn Hatfield  
Borough Council License No. LA 100019547 2019